



SOFFIT INSULATION

URSA WALLTEC REFLEX, URSA WALLTEC BLACK & URSAPAN BLACK

URSA WALLTEC REFLEX is a lightweight, non-combustible, semi-rigid glass mineral wool slab treated with a silicon-based water repellent additive. It is faced on one side with a micro-perforated aluminium foil.

Thickness
128, 138 & 157mm

Thermal Conductivity 0.032 W/mK

Density (nominal) 32 kg/m³

URSA WALLTEC BLACK and **URSAPAN BLACK** are lightweight, non-combustible, semi-rigid glass mineral wool slabs treated with a silicon-based water repellent additive. Faced on one side with a black glass tissue fleece.

URSA WALLTEC BLACK

Thickness
60, 80, 100, 120, 140, 150, 160, 180,
200 & 220mm

Thermal Conductivity 0.032 W/mK

Density (nominal) 32 kg/m³

URSAPAN BLACK

Thickness
100, 120, 140, 150, 160, 180, 200, 220 &
240mm

Thermal Conductivity 0.035 W/mK

Density (nominal) 22 kg/m³

Dimensions 1350mm x 600mm

Fire Performance Euroclass A1 (non-combustible)
(BS EN 13501-1)

BRE Green Guide Rating A+

Manufacturing Standards BS EN 13162, BS EN ISO 9001 & BS EN ISO 14001

General Detail

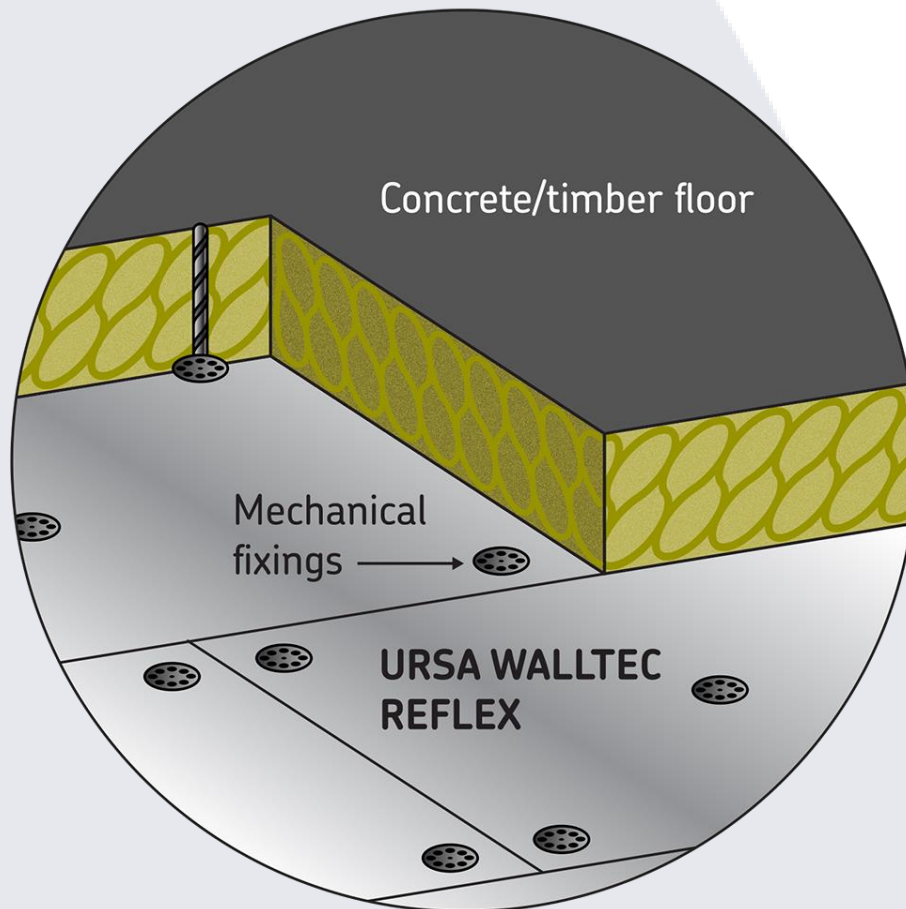

Soffit fixing Instructions

Use screw or expansion fixings suitable for concrete (or other substrate) with 70mm (minimum diameter) washer. Use 5 fixings per board, at least one metal fixing centrally and the others 100mm from each corner. Do not overdrive or overtighten the fixings. Boards to be tightly butt jointed.

U-Values

Typical Construction.
200mm reinforced concrete slab
URSA WALLTEC REFLEX

URSA WALLTEC REFLEX	U-Value (W/m ² K)
128mm	0.23
138mm	0.21
157mm	0.19